

LEGEND

- SID APPLICATION SITE BOUNDARY
- PROPOSED DEVELOPMENT
- PROPOSED EIRGRID SECURITY FENCE
- PROPOSED EIRGRID POST & RAIL BOUNDARY FENCE

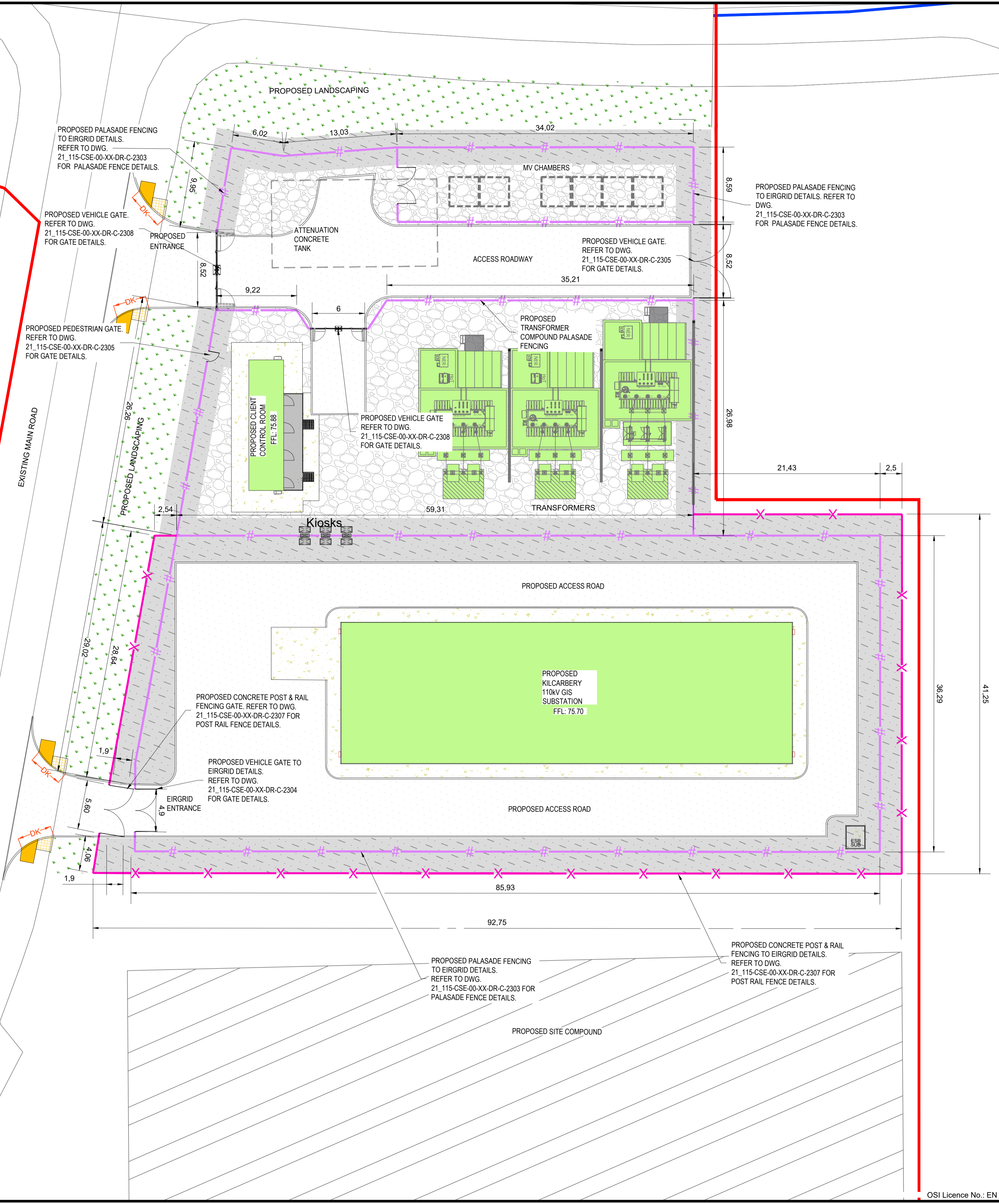

NOTE:  
REFER TO ARCHITECTS DRAWING FOR FENCING DETAILS.

Rev	Description	Drawn	Checked	Date
P04	SID ISSUE	DM	PM	04.02.2022
P03	DRAFT SID ISSUE	DM	PM	10.12.2021
P02	SID SCHEME ISSUE	DM	PM	26.11.2021
P01	WIP	DM	PM	22.10.2021

**Clifton Scannell Emerson Associates Limited**

Consulting Engineers,  
3rd Floor The Highline,  
Bakers Point, Pottery Road,  
Dun Laoghaire, Co. Dublin,  
Ireland, A96 KW29

T. +353 1 288 5006  
F. +353 1 283 3466  
E. info@csea.ie  
W. www.csea.ie

**VANTAGE DATA CENTERS**

Client: **KILCARBERY 110KV SUBSTATION & MV CLIENT COMPOUND**

Project: **PROPOSED FENCING LAYOUT PLAN**

Dwg. Title: **21\_115**

Drawn By: **DM** Date: **OCT 2021**

Checked By: **PM** Scale: **1:250 @ A1**

Project Code: **21\_115 - CSE - 00 - XX - DR - C - 2105**

Status Code: **S2** Suitability Description: **PRELIMINARY**

Revision: **P04** Project Status: **PRELIMINARY**